

General Notes:

Zoning:	Village centre
Site Area :	0.65HA
Plot ratio:	0.12 max:0.5 - 0.35
Site coverage:	9.2% Max 50%
Residential Density:	15.4 Units/HA Recommended, 15-20 lower in some cases
Open Space:	0.12HA, 18.4% Min 15%
Services:	
Water:	Access to public mains
Foul:	Access to public sewer
Surface Water:	soakaways on site

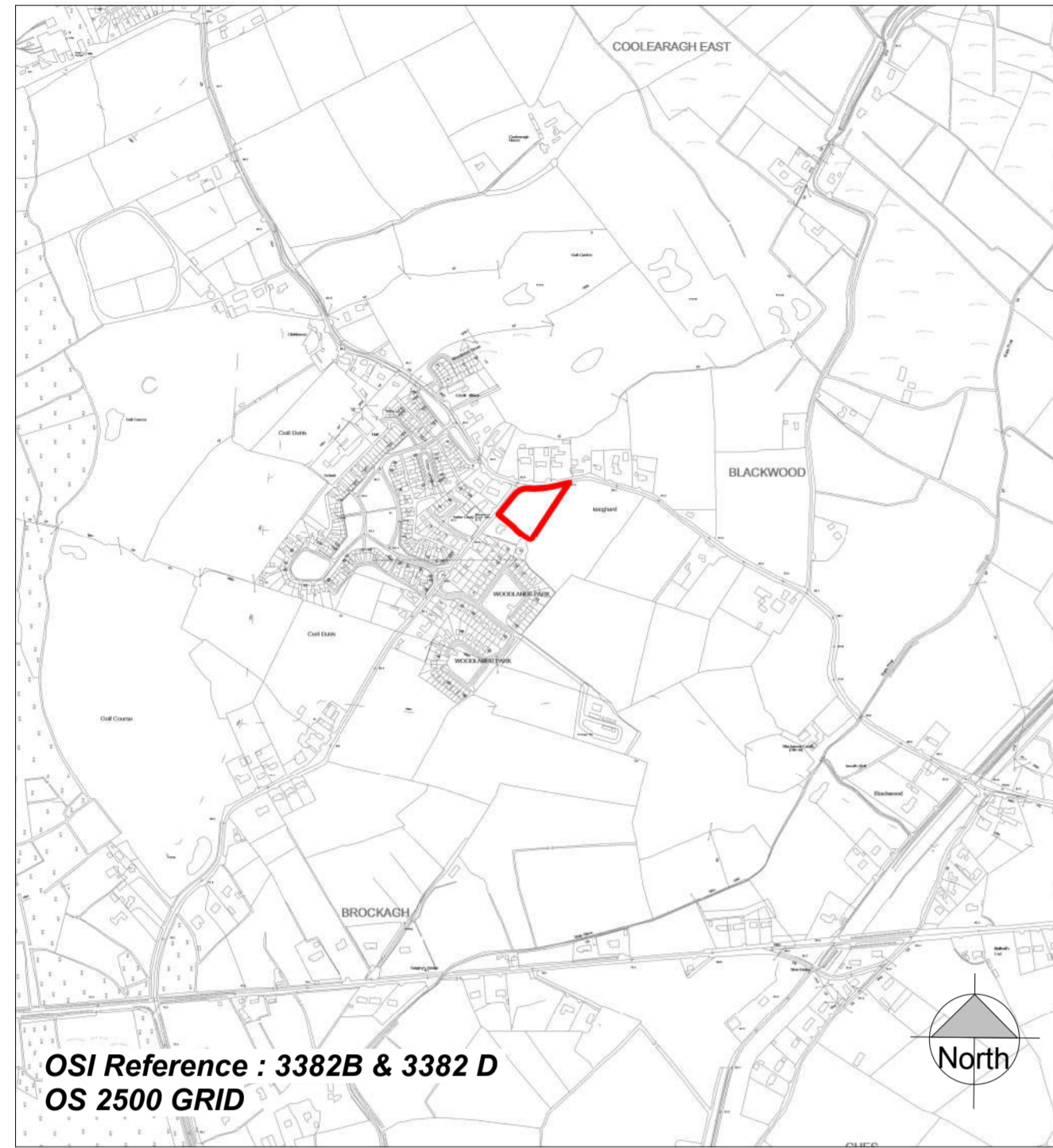

OSI Reference : 3382B & 3382 D
OS 2500 GRID

© Ordnance Survey Ireland Licence No. 2012/26/CCMA/Kildare County Council

Site Location Map 2
Scale @ A1: 1 : 10620

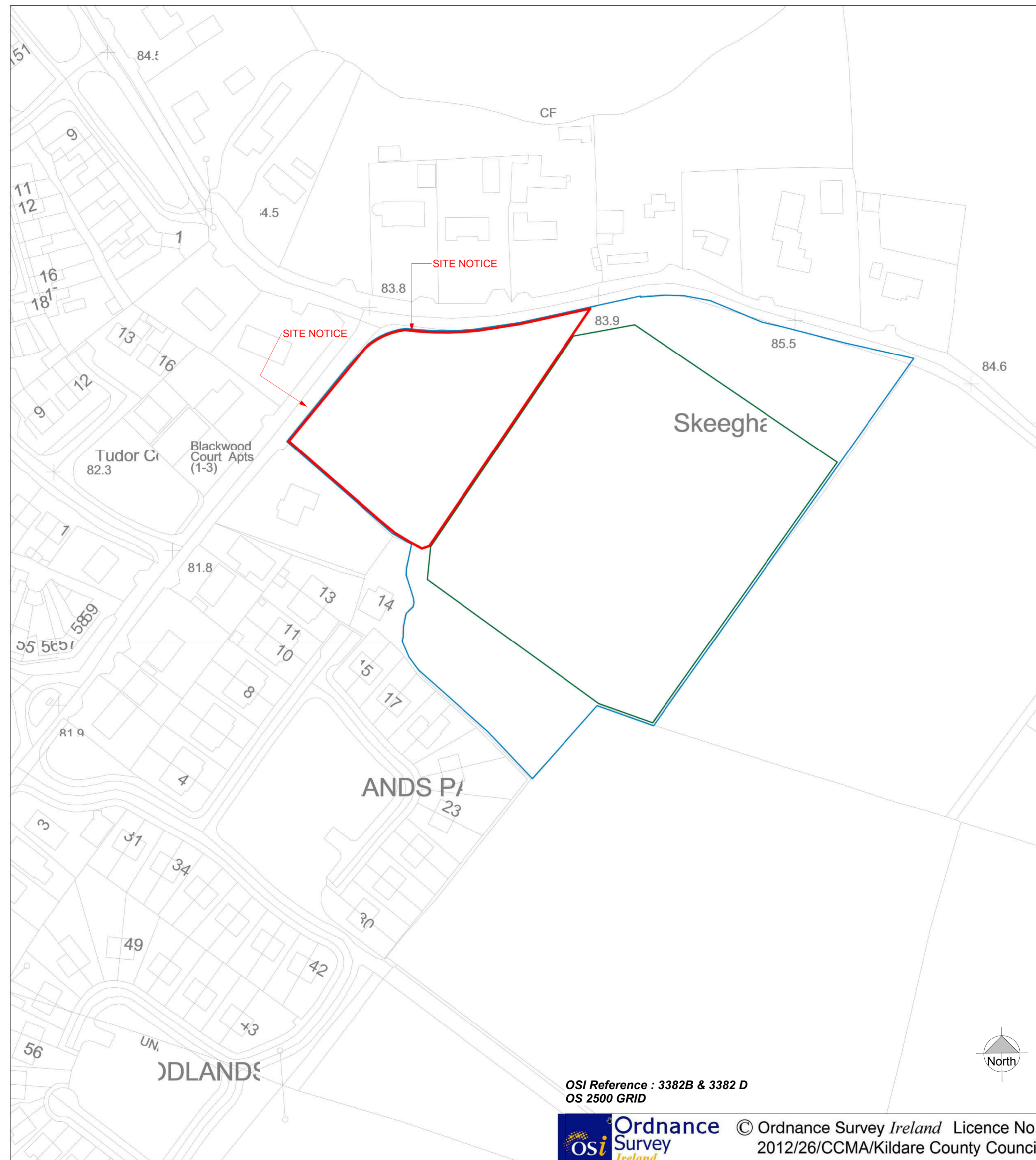

Extent of site	0.650HA
Lands in ownership of KCC	2.930HA
Lands Leased to Soccer club	1.595HA

OSI Reference : 3382B & 3382 D
OS 2500 GRID

© Ordnance Survey Ireland Licence No. 2012/26/CCMA/Kildare County Council

Site Location Map
Scale @ A1: 1 : 1000

PART 8 APPLICATION

- Notes:**
- This drawing has been prepared for planning purposes only
 - All drawings to be read in conjunction with all other consultant drawings, Architect to be informed immediately of any discrepancies
 - Figured dimensions only to be taken from this drawing. All dimensions and levels to be checked on site, Architect to be informed immediately of any discrepancies

REVISION

REV	NOTES	DATE

Kildare County Council,
Architectural Services Section,
Devoy Park,
Naas,
Co. Kildare



Project:
Proposed 10 no. Social Houses and associated works at Coill Dubh, Co. Kildare.

Client:
Tadhg McDonnell, Director of Housing

Prepared By: Capital Housing Team,
Architectural Services Section,
Housing Department,
Kildare County Council
Senior Architect: David Creighton, MRIAI
Senior Executive Architect: Leitita Hanratty, MRIAI
Project Manager: Patrick Henderson, MRIAI

Dwg : Site Location maps	Project No: 17-027
Scale : As indicated@A1	Dwg No: P8-02

Drawn By: PH Checked By: LH Date: 10/09/2018 10:52:29